

**Product** **DFC2025HP250A1**

**Specification**

<b>Cut-off Frequency</b>	1900.0MHz
<b>Bandwidth[BW]</b>	250MHz
<b>Insertion Loss in BW</b>	2.5 dB max.
<b>Ripple in BW</b>	1.1 max. in 36MHz
<b>VSWR (in BW)</b>	2.5:1 max.
<b>Attenuation [Absolute Value]</b>	25.0 min. @ 1842 MHz
<b>In/Out Impedance</b>	50Ω
<b>Input Power</b>	1 w max.
<b>Operation Temperature</b>	-40°C ~ +85 °C

**Dimension (mm)**

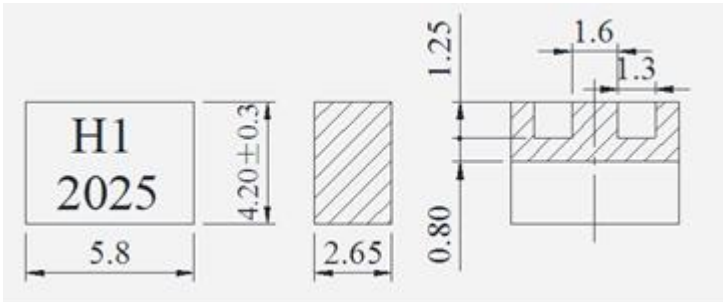

TOLERANCE:±0.1 UNIT:mm

**TEST GRAPH**

