

Product **DFC5665G370A**

Specification

Center Frequency[fo]	5665.0MHz
Bandwidth[BW]	±185MHz
Insertion Loss in BW	3.0 dB max.
Ripple in BW	1.0 dB max.
VSWR in BW	1.9:1max.
Attenuation [Absolute Value]	30.0 min @ 2400 to 2500 MHz 25.0 min @ 5150 to 5340 MHz
In/Out Impedance	50Ω
Input Power	1 w max.
Operation Temperature	-40°C ~ +85 °C

Dimension (mm)

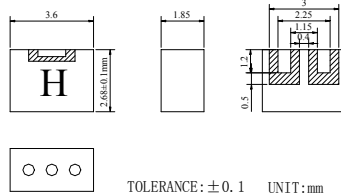

TEST GRAPH

