

Product **DFD5697S360DF**

Specification

Center Frequency[fo]	5670.0MHz
Bandwidth[BW]	±180MHz
Insertion Loss in BW	2.5 dB max.
Ripple in BW	1.3 dB max.
Return Loss in BW	10.0dB min.
Attenuation [Absolute Value]	50.0 min @ 5150 to 5330 MHz
In/Out Impedance	50Ω
Input Power	1 w max.
Operation Temperature	-40°C ~ +85 °C

Dimension (mm)

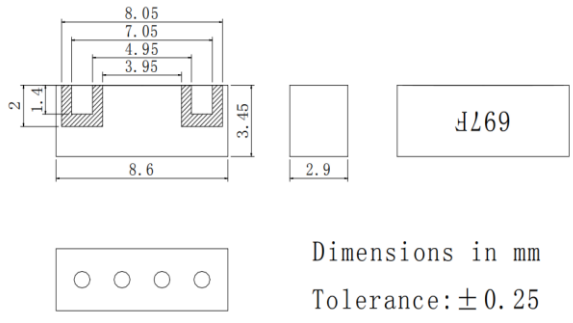

TEST GRAPH

